

FOR LEASE | ±19,421 S.F.

1010 N. EDWARD COURT, ANAHEIM, CALIFORNIA

FREEWAY FRONTAGE INDUSTRIAL BUILDING



For information, contact:

BEN SEYBOLD

T 714.939.2136

ben.seybold@cbre.com

www.cbre.com/ben.seybold

SEAN WARD

T 714.939.2294

sean.ward@cbre.com

www.cbre.com/sean.ward

CB Richard Ellis
2125 E. Katella Avenue
Suite 100
Anaheim, CA 92806
T 714.939.2100
F 714.939.2170

www.cbre.com

CBRE
CB RICHARD ELLIS

BUILDING SPECIFICATIONS:

Total Unit Area: ±19,421 SF

- Warehouse Area: ±14,921 SF
- Office Area: ±4,500 SF
- Dock-High Doors: 2
- Grade Level Doors: 1
- Up to Two (2) Additional Loading

Doors Possible

- Power Supply: 800 Amp;
277/480 Volt (verify)
- Direct 91 Freeway Frontage
- 28' Minimum Warehouse
Clearance
- Fully Fire Sprinklered
- Possible Yard Area

BUILDING FEATURES:

- Major Freeway Exposure
- Over 400,000 Vehicles Per Day

PROPERTY FEATURES:

- Easy Access to 91, 57, 5 &
55 Freeways

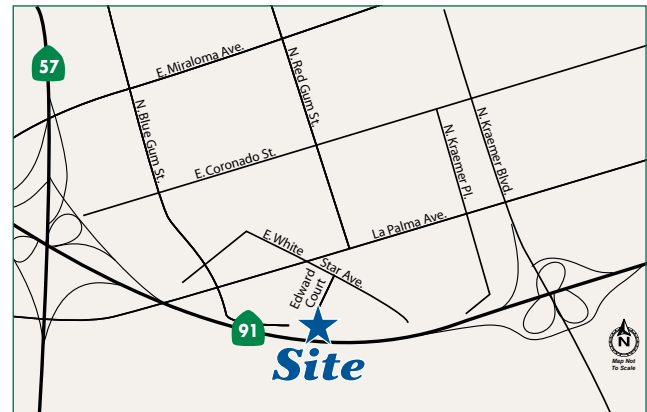

©2007, CB Richard Ellis, Inc. We obtained the information above from sources we believe to be reliable. However, we have not verified its accuracy and make no guarantee, warranty or representation about it. It is submitted subject to the possibility of errors, omissions, change of price, rental or other conditions, prior sale, lease or financing, or withdrawal without notice. We include projections, opinions, assumptions or estimates for example only, and they may not represent current or future performance of the property. You and your tax and legal advisors should conduct your own investigation of the property and transaction. BT0706 Team Stuff\SW Team\1010EdwardCourt\FL_1010EdwardCourt_a.indd

FOR LEASE | ±19,421 S.F.

1010 N. EDWARD COURT, ANAHEIM, CALIFORNIA

**FREEWAY
FRONTAGE
INDUSTRIAL
BUILDING**



EXISTING SITE PLAN

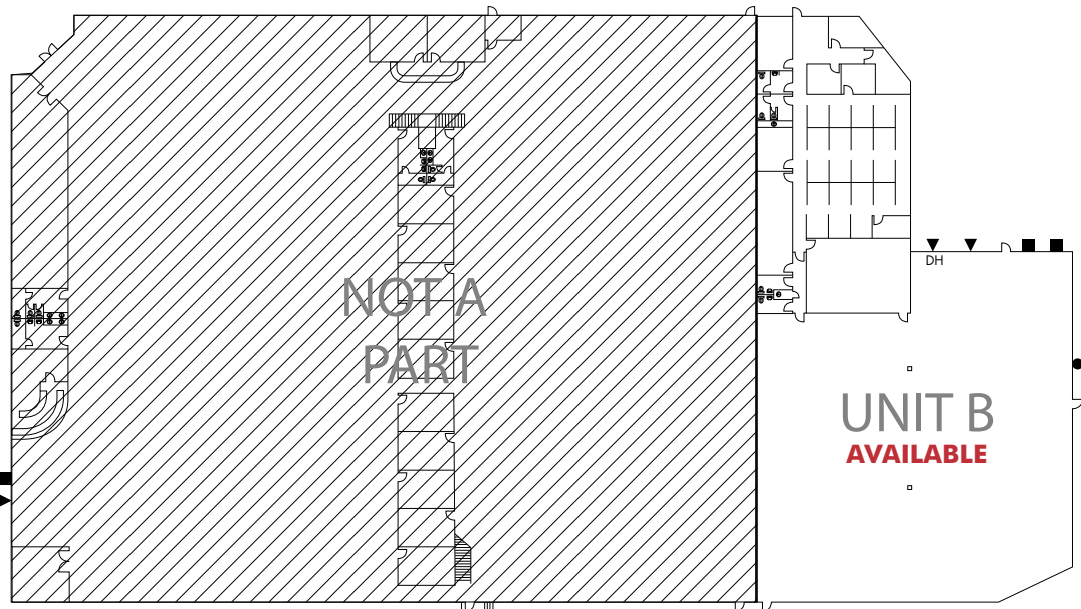

91 FREEWAY

- ▼ Dock High
- Grade Level
- Additional Loading Possible

For information, contact:

BEN SEYBOLD

T 714.939.2136

ben.seybold@cbre.com

www.cbre.com/ben.seybold

SEAN WARD

T 714.939.2294

sean.ward@cbre.com

www.cbre.com/sean.ward

CB Richard Ellis
2125 E. Katella Avenue
Suite 100
Anaheim, CA 92806
T 714.939.2100
F 714.939.2170

www.cbre.com

CBRE
CB RICHARD ELLIS

©2007, CB Richard Ellis, Inc. We obtained the information above from sources we believe to be reliable. However, we have not verified its accuracy and make no guarantee, warranty or representation about it. It is submitted subject to the possibility of errors, omissions, change of price, rental or other conditions, prior sale, lease or financing, or withdrawal without notice. We include projections, opinions, assumptions or estimates for example only, and they may not represent current or future performance of the property. You and your tax and legal advisors should conduct your own investigation of the property and transaction. BT0706 Team Stuff\SW Team\1010EdwardCourt\FL_1010EdwardCourt_a.indd